



**COMMISSIONERS COURT  
COMMUNICATION**

COURT ORDER NUMBER 144941

PAGE 1 OF 3

DATE: 4/2/2025

**SUBJECT: CONSIDERATION OF A BUILDING RENOVATION FOR COURTROOMS  
A AND B OF THE SCOTT D. MOORE JUVENILE JUSTICE CENTER**

**\*\*\* CONSENT AGENDA \*\*\***

**COMMISSIONERS COURT ACTION REQUESTED**

It is requested that the Commissioners Court consider a building renovation of Courtrooms A and B of the Scott D. Moore Juvenile Justice Center.

**BACKGROUND**

In the approved FY 2025 budget, the Commissioners Court allocated \$45,100.00 for the renovation of Courtrooms A and B at the Scott D. Moore Juvenile Justice Center.

The renovation creates two (2) multi-purpose rooms designed for training, meetings, and other similar events requiring a large space. The project includes the removal of all courtroom-related benches, seating, and walls, as well as the addition of four (4) electrical outlets, a data drop, and forty-six (46) light fixtures. All furnishings will be supplied by Juvenile Services.

The renovation consists of demolition, millwork installation, and updates to electrical, lighting, data, and carpet.

**FISCAL IMPACT**

Funding in the amount of \$40,907 is available in account 45100-2025 Non-Debt Capital/3110309000 Juvenile Center/54000 Capital and is within the previously approved budget.

SUBMITTED BY	Facilities Management	PREPARED BY:	Milissa Warner
		APPROVED BY:	Frank Lopez

## Juvenile Center Courtroom Renovation

Budget Estimate date 12/19/24

*The budget below is based from the following scope of work:*

1. *This budget includes a total of 3406 sq ft located at address. Scott D. Moore Juvenile Detention Center*
3. *This budget does not include relocation costs.*
4. *This budget does not include annual operating costs.*

### Capital Budget Summary

1. SITE WORK		\$	-
2. DEMOLITION / ABATEMENT		\$	1,080.00
3. CONSTRUCTION COST OF THE BUILDING		\$	37,878.95
General Requirements	\$	-	
Concrete	\$	-	
Gypsum Board Assemblies	\$	-	
Openings	\$	-	
Finishes	\$	27,148.00	
Elevator	\$	-	
Mechanical Systems	\$	-	
Electrical Systems	\$	10,730.95	
Plumbing Systems	\$	-	
Special Equipment	\$	-	
Low Voltage	\$	-	
General Contractor (1 if bid out, 0 if performed in-house)	\$	-	
4. PROFESSIONAL SERVICES			\$0
Pre-design (programming, preliminary drawings, site alternates)	\$	-	
Full Architect / Engineering Services (triggered if HC is > \$50,000)	\$	-	
Lab Design Consultant	\$	-	
Geotechnical Survey	\$	-	
Phase 1 / 2 Asbestos Surveys	\$	-	
Inspections / Testing	\$	-	
HVAC - Test and Balance	\$	-	
Commissioning - LEED	\$	-	
Document Reproduction	\$	-	
5. PERMITS & FEES		\$	-
6. Occupancy Expenses		\$	-
7. OWNER'S CONTINGENCY		\$	1,947.95
Tarrant County Facilities Management			
<b>TOTAL PROJECT BUDGET : If Self-Performed</b>			<b>\$ 40,906.90</b>

Cost of Self-Performed Tradesmen

\$ -

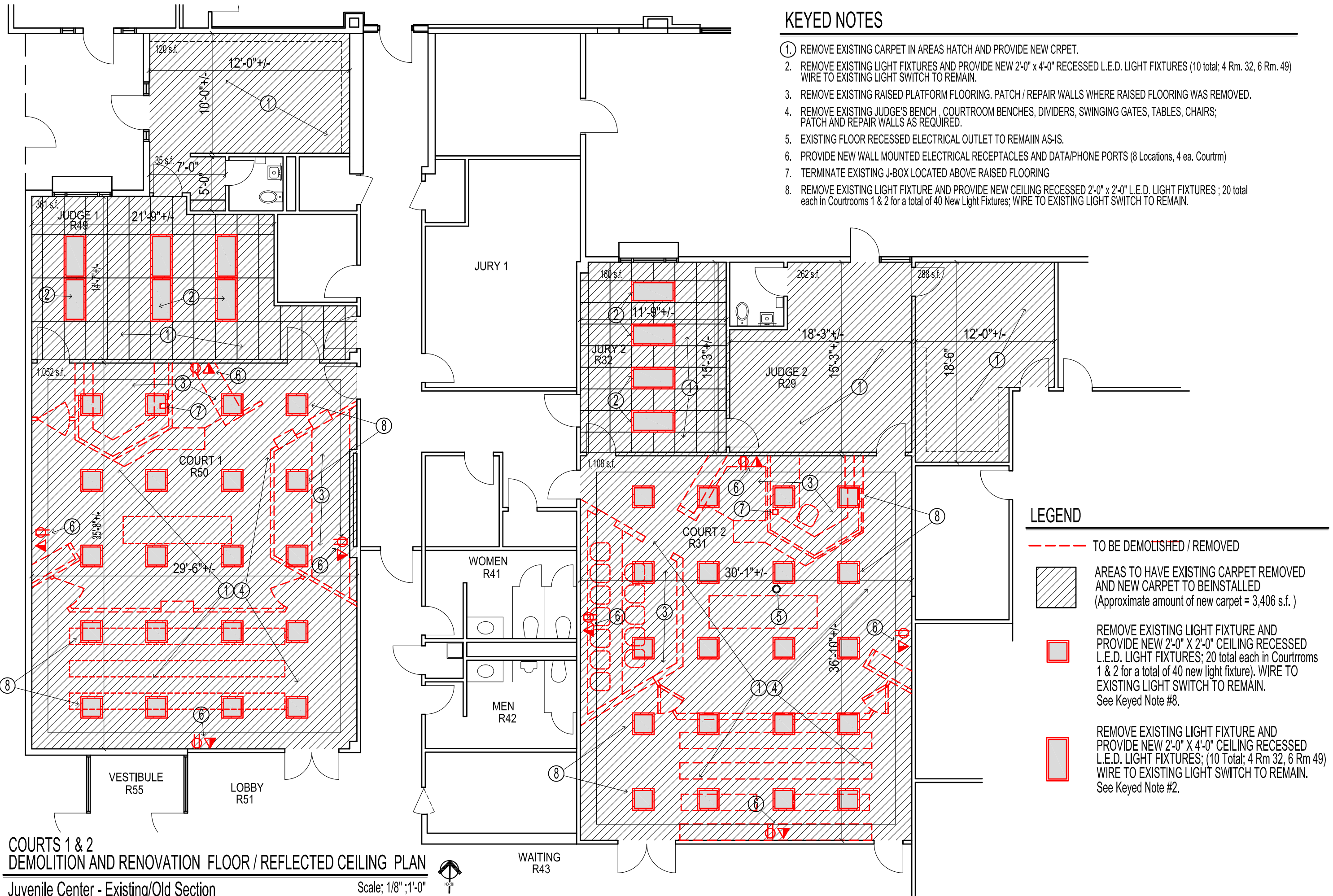

### KEYED NOTES

1. REMOVE EXISTING CARPET IN AREAS HATCH AND PROVIDE NEW CRPET.
2. REMOVE EXISTING LIGHT FIXTURES AND PROVIDE NEW 2'-0" x 4'-0" RECESSED L.E.D. LIGHT FIXTURES (10 total; 4 Rm. 32, 6 Rm. 49) WIRE TO EXISTING LIGHT SWITCH TO REMAIN.
3. REMOVE EXISTING RAISED PLATFORM FLOORING. PATCH / REPAIR WALLS WHERE RAISED FLOORING WAS REMOVED.
4. REMOVE EXISTING JUDGE'S BENCH, COURTROOM BENCHES, DIVIDERS, SWINGING GATES, TABLES, CHAIRS; PATCH AND REPAIR WALLS AS REQUIRED.
5. EXISTING FLOOR RECESSED ELECTRICAL OUTLET TO REMAIN AS-IS.
6. PROVIDE NEW WALL MOUNTED ELECTRICAL RECEPTACLES AND DATA/PHONE PORTS (8 Locations, 4 ea. Courtm)
7. TERMINATE EXISTING J-BOX LOCATED ABOVE RAISED FLOORING
8. REMOVE EXISTING LIGHT FIXTURE AND PROVIDE NEW CEILING RECESSED 2'-0" x 2'-0" L.E.D. LIGHT FIXTURES ; 20 total each in Courtrooms 1 & 2 for a total of 40 New Light Fixtures; WIRE TO EXISTING LIGHT SWITCH TO REMAIN.

### LEGEND

- - - - - TO BE DEMOLISHED / REMOVED
- AREAS TO HAVE EXISTING CARPET REMOVED AND NEW CARPET TO BEINSTALLED (Approximate amount of new carpet = 3,406 s.f.)
- REMOVE EXISTING LIGHT FIXTURE AND PROVIDE NEW 2'-0" X 2'-0" CEILING RECESSED L.E.D. LIGHT FIXTURES; 20 total each in Courtrooms 1 & 2 for a total of 40 new light fixture). WIRE TO EXISTING LIGHT SWITCH TO REMAIN. See Keyed Note #8.
- REMOVE EXISTING LIGHT FIXTURE AND PROVIDE NEW 2'-0" X 4'-0" CEILING RECESSED L.E.D. LIGHT FIXTURES; (10 Total; 4 Rm 32, 6 Rm 49) WIRE TO EXISTING LIGHT SWITCH TO REMAIN. See Keyed Note #2.

**COURTS 1 & 2  
DEMOLITION AND RENOVATION FLOOR / REFLECTED CEILING PLAN**  
Juvenile Center - Existing/Old Section

Scale: 1/8" = 1'-0"



Tarrant County - Facilities Management  
Construction Services  
100 W. Weatherford St. Room 350  
Fort Worth, Texas 76196  
p: (817) 884-1502

COURTS 1 & 2 DEMILITION AND RENOVATION  
JUVENILE CENTER

FLOOR PLAN AND KEYED NOTES

DRAWING NUMBER  
Juvenile Crt1&2 Demo Renov  
DATE: January 30, 2025  
DRAWN BY: H.C.

SHEET NO.  
**A-1**  
1 OF 1 SHEETS